

SPECIFICATIONS

- Made entirely of AISI 316L
- Suitable for DOE/SOE/COD.8/COD.3 cartridges
- Max. operating pressure: 8 bar
- Max operating temperature: 60°C
- Available with threaded (G) or flanged (F) fittings
- Connections: Threaded 1/2" - 4" M/F and Flanged DN15- DN100
- Execution: Side/Bottom (L) – Side/Side (Z)
- Quick-Lock system: V-Clamp
- Gaskets: EPDM - VITON - SILICONE
- Body finish: pickling / Electro-polishing (int. / ext.)
- Compliance with Directive 2014/68/EU PED Art 4 Par.3
- Construction in accordance with VSR-95 Ed.1999
- Suitable for containing H.10"-20"-30"-40" cartridges

APPLICATIONS

- Filtration for group 2 process fluids (non-hazardous)
- Reverse osmosis pre-filters
- Potable and process water
- Paints, inks and coatings
- Detergents
- Refrigerants
- Lubricants, cutting oils

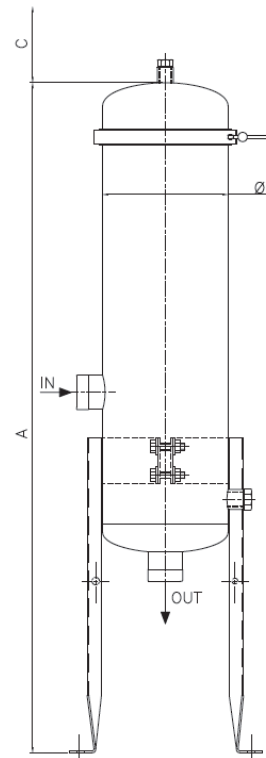
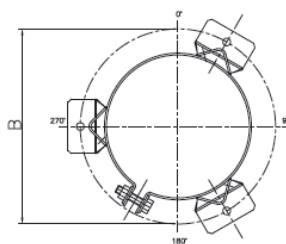

Model Code	No. Cartridges x Height	In / Out Connections		Dimensions (mm) AxBxC - ØD	*Flow rate m³/h	Weight kg
		G = Threaded	F = Flanged			
MLCT-P-VC-310	3 x 10"	1.5" BSP M	DN40	667 x 247 x 250 - Ø168.3	4.5	14.8
MLCT-P-VC-320	3 x 20"	1.5" BSP M	DN40	932 x 247 x 500 - Ø168.3	9	17.3
MLCT-P-VC-330	3 x 30"	1.5" BSP M	DN40	1202 x 247 x 750 - Ø168.3	13.5	19.8
MLCT-P-VC-340	3 x 40"	1.5" BSP M	DN40	1452 x 247 x 1000 - Ø168.3	18	22.3
MLCT-P-VC-510	5 x 10"	2" BSP M	DN50	799 x 305 x 250 - Ø219.1	7.5	16.5
MLCT-P-VC-520	5 x 20"	2" BSP M	DN50	1055 x 305 x 500 - Ø219.1	15	19
MLCT-P-VC-530	5 x 30"	2" BSP M	DN50	1325 x 305 x 750 - Ø219.1	22.5	21.5
MLCT-P-VC-540	5 x 40"	2" BSP M	DN50	1575 x 305 x 1000 - Ø219.1	30	24
MLCT-P-VC-610	6 x 10"	2" BSP M	DN50	799 x 305 x 250 - Ø219.1	9	16.5
MLCT-P-VC-620	6 x 20"	2" BSP M	DN50	1055 x 305 x 500 - Ø219.1	18	19
MLCT-P-VC-630	6 x 30"	2" BSP M	DN50	1325 x 305 x 750 - Ø219.1	27	21.5
MLCT-P-VC-640	6 x 40"	2" BSP M	DN50	1575 x 305 x 1000 - Ø219.1	36	24
MLCT-P-VC-720	7 x 20"	2.5" BSP M	DN65	1055 x 305 x 500 - Ø219.1	21	19
MLCT-P-VC-730	7 x 30"	2.5" BSP M	DN65	1325 x 305 x 750 - Ø219.1	31	21.5
MLCT-P-VC-740	7 x 40"	2.5" BSP M	DN65	1575 x 305 x 1000 - Ø219.1	42	24
MLCT-P-VC-920	9 x 20"	3" BSP M	DN80	1240 x 355 x 500 - Ø273	27	31
MLCT-P-VC-930	9 x 30"	3" BSP M	DN80	1510 x 355 x 750 - Ø273	40	34.5
MLCT-P-VC-940	9 x 40"	3" BSP M	DN80	1760 x 355 x 1000 - Ø273	54	37

* Flow rate based on liquids with the same viscosity as water with 25 µm filtration degree and initial pressure drop of 0.2 bar