

SELF-CLEANING FILTERS - SCF

SCF series self-cleaning filters provide a viable filtration solution for a wide variety of liquids, including very high viscosities.

Cleaning of the filter element takes place with no interruption in flow and no loss of pressure or loss of liquid.

There is no operator contact with the process liquid, making it ideal for hazardous liquid applications.

The cleaning stage may be activated manually via an external knob or in fully automated mode.

SPECIFICATIONS

- Cast iron, carbon steel and stainless steel body construction
- AISI 316 filter elements
- Filtration from 25 µm to 6 mm
- DN40 to DN100 connections
- Pressures: 14 bar std. – 50 bar for HP applications

APPLICATIONS

- Filtration of epoxy resins, polyurethanes, adhesives, glues, even highly viscous, to replace sieves or vibratory screens.
- Filtration of paints, varnishes and inks
- Filtration of wash water, on mechanical seals, on pumps in the pulp and paper industry.
- Filtration of fuel, lubrication and cooling oils on machine tools
- In oil industry, food industry for chocolate production



Diagramma di flusso per un filtro con elemento filtrante da 1000 my riferito ad acqua
Pressione differenziale (bar)

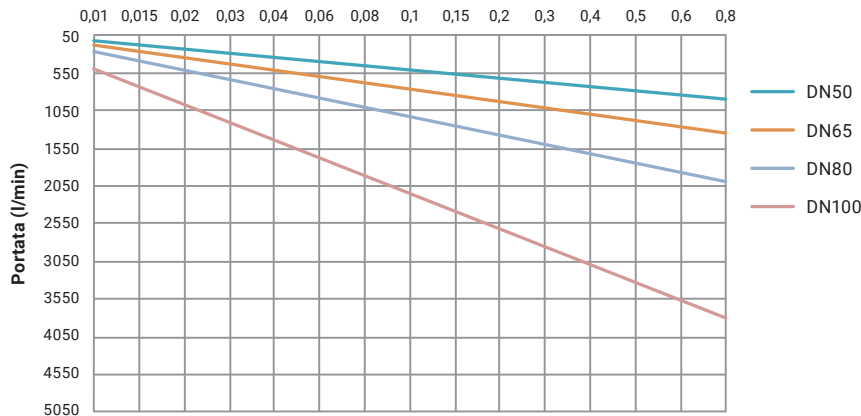

Viscosity (cSt)	50 µm	100 µm	200 µm	500 µm	1000 µm
1	1.5	1.2	1.13	1.08	1.0
50	3.6	2.75	2.4	2.2	1.75
200	5	3.67	3.16	2.84	2.1
500	6.2	4.5	3.8	3.35	2.4
1000	7.6	6	5	3.9	3.6
5000	34	27	22	18	17

Multiply the Δp in the diagram by the factor related to the viscosity and the grade of the filter element.

Flanged, motorised filter

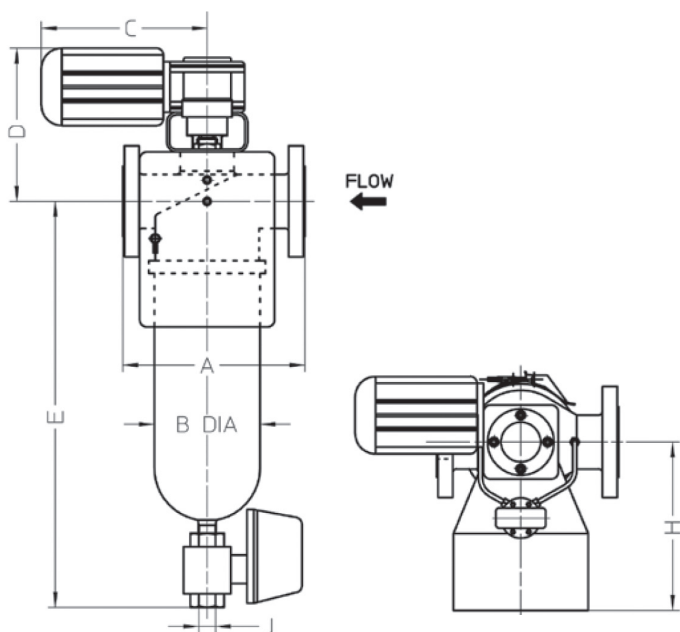

Threaded, manual filter

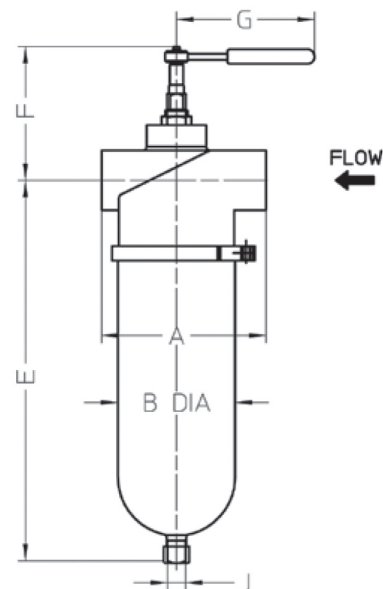

Connections Size	Dimensions (mm)										Dry weight (kg)			
	Flanged	Threaded	B	C	D	E	F	G	H	J	Flanged		Threaded	
	A	A									M	MT	M	MT
DN40	270	220	157	260	245	555	150	185	250	3/4"	24	35	18	29
DN50	270	220	157	260	245	555	150	185	250	3/4"	24	35	18	29
DN65	270	220	157	260	245	555	150	185	250	3/4"	24	35	18	29
DN80	299	-	192	260	255	645	190	185	250	1" 1/2	50	55	-	-
DN100	430	-	280	350	380	880	295	510	300	1" 1/2	285	385	-	-

COMPOSITION CODE	SCF	MT	DN65	F	M2	3000
	Mod	Version	IN/ OUT connections	Connection type	Material	Basket filtration
			M = Manual MT = Motorised	DN40 DN50 DN65 DN80 DN100	F = Flanged or G = Threaded Only F = Flanged	M2 = AISI 316